

# PG-4840-N-107USNL

## 48x40 (Standard) Plastic Industrial Pallet



### Technical Data

Dimensions 48x40x5.1 inches  
Weight 11.5 lbs

#### Load Capacities

Static 3300 lbs  
Dynamic 2100 lbs  
Racking --

Entry 4-way  
Truckload Qty 2370  
Stack TL 79

TL (truckload) quantities are approximate and may vary by transport equipment or other factors.

### Handling Data

<b>Nestable</b> Yes	<b>Reusability</b> One-Way & Multi-Trip	<b>ISPM-15 Exempt</b> Yes
<b>Stackable</b> No	<b>Destination</b> Export & Captive	<b>Food Grade</b> Yes, non-FDA
<b>Rackable</b> No	<b>Airfreight</b> Yes	<b>Pharmaceutical</b> Yes

### Materials and Colors

**Condition**  
New

**Material**  
HDPE/PP (Recycled)

**Color**  
Black

(High-Density Polyethylene/Polypropylene)

### Deck Specs

**Top Deck**  
Open

**Bottom Deck**  
9 Feet - Nesting

#### Available Options:

Closed Top Deck  
3-Runner Bottom Deck (for stacking unit loads)  
With perimeter lip = PG-4840-N-107US

### Features

- Available in food-grade FDA material
- Top deck has no lips or safety tabs
- Designed to easily secure wrapping
- Nesting saves storage & shipping costs
- Easy-to-clean hygienic design
- Suitable for packaged food items  
(not approved for direct food contact)
- Impervious to acids, fats, solvents and odors
- Resists water absorption & bacteria growth
- Inert to infestation, mold and mildew
- Consistently dimensionally accurate
- Exempt from ISPM 15 shipping regulations



**Nelson**<sup>TM</sup>

The Nelson Company

(443) 649-5294

[plastic@NelsonCompany.com](mailto:plastic@NelsonCompany.com)

[www.NelsonCompany.com](http://www.NelsonCompany.com)

[www.NelsonTechCenter.com](http://www.NelsonTechCenter.com)

# PG-4840-N-107USNL

48x40 (Standard)  
Plastic Industrial Pallet



## Technical Drawings

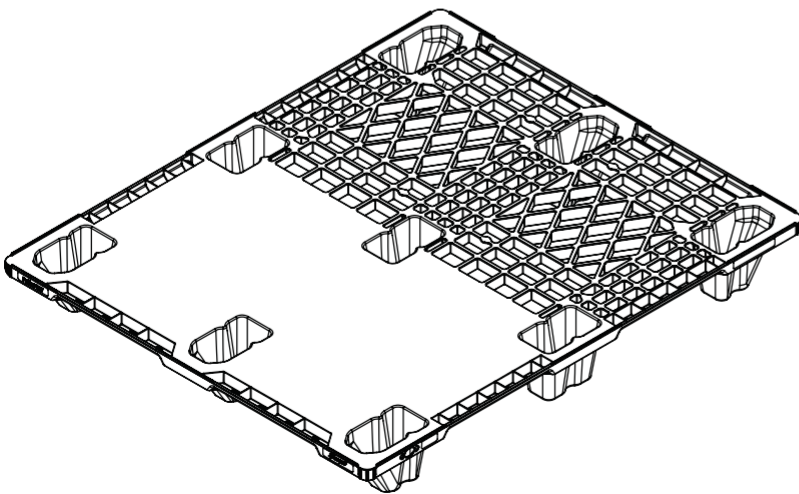
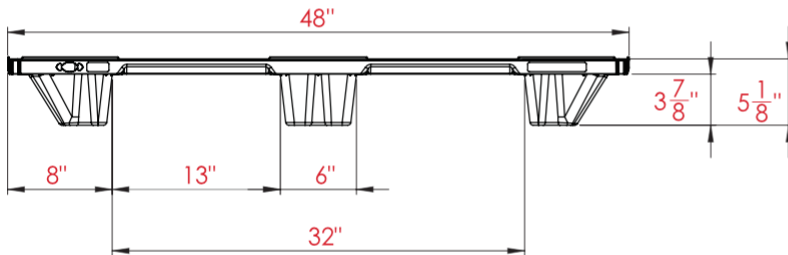
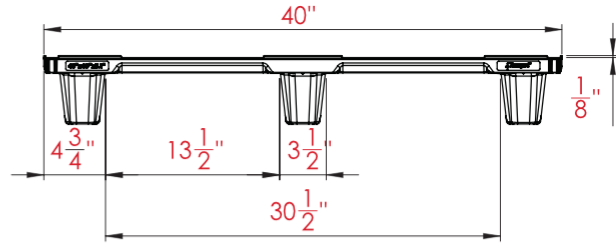
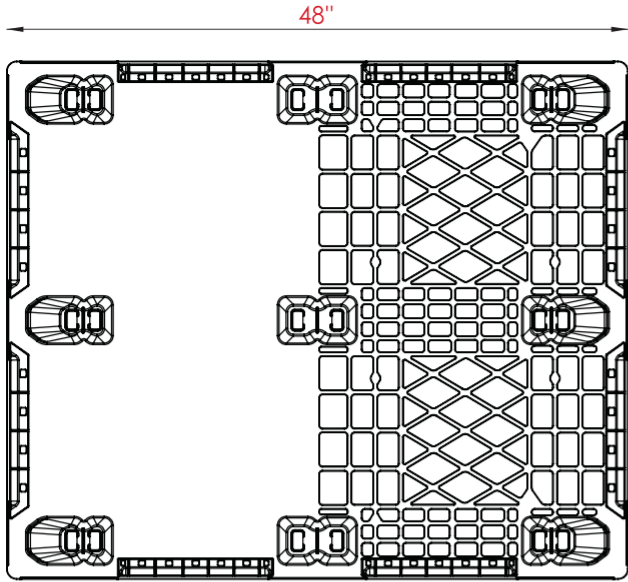

**Nelson**™

The Nelson Company

(443) 649-5294

[plastic@NelsonCompany.com](mailto:plastic@NelsonCompany.com)

[www.NelsonCompany.com](http://www.NelsonCompany.com)

[www.NelsonTechCenter.com](http://www.NelsonTechCenter.com)

Tech Sheet Generated On: 5/18/2024

Specs subject to change without notice. Provided for informational purposes only. Technical data are guideline values and may vary based on intended use, features, raw materials and environment. Nothing shall be construed as warranties or guarantees, express or implied, regarding products or their use, application, performance or otherwise.