

NPP-4840-FP-E6OD-FDA

48x40 (Standard) Plastic Industrial Pallet



Technical Data

Dimensions 48x40x6.1 inches (1219x1016x155 mm)
Weight 34.0 lbs

Load Capacities

Static 8800 lbs
Dynamic 4400 lbs
Racking 2200 lbs

Entry 4-way
Pallets per Stack 17
Truckload Qty 510

Available in Truckload or LTL quantities. Minimum quantity required. We reserve the right to change any stated information without prior notice. Not responsible for typographical errors.

Handling Data

Nestable
No

Reusability
Multi-Trip

ISPM-15 Exempt
Yes

Stackable
Yes

Destination
Captive

Food Grade
FDA Approved

Rackable
Yes

Airfreight
Yes

Pharmaceutical
Yes

Materials and Colors

Condition
New

Material HDPP **Color** Blue

(Virgin)

Deck Specs

Top Deck
Open

Bottom Deck
6 Runner - Perimeter+2 Cross
(cruciform perimeter base)

Available Options:
RFID Transponders
Individual Markings
Anti-Slip Bottom Grommets
ESD Prevention for Anti-Static
FDA Version with Freezer Additives
Rod Inserts for Increased Performance.

Features

Ideal for closed loops or distribution chains across industry sectors including Food, Retail, Medical and Pharmaceutical.

- High performance at low cost
- Top Safety Rim
- Open deck flow-thru design
- Allows for safe double stacking
- Sanitary choice for strict drug manufacturing requirements
- Impervious to acids, fats, solvents and odors
- Resists water absorption & bacteria growth
- Inert to infestation, mold and mildew
- Consistently dimensionally accurate
- Exempt from ISPM 15 shipping regulations

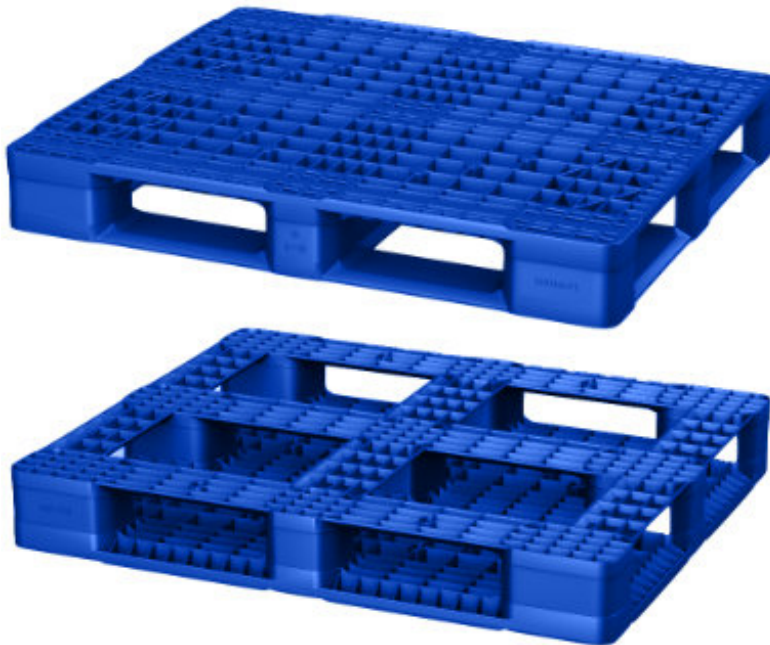

Spec Sheet Generated On: 1/28/2023

Specifications subject to change without notice.

Contents of this document are presented for general informational purposes only. Technical data are guideline values based on experience and tests under defined conditions. The data may vary based on intended use, product features, raw materials used and environmental influences. Nothing in this document shall be construed as warranties or guarantees, express or implied, regarding the products or their use, application, performance or otherwise.

Nelson™

The Nelson Company

(443) 649-5294

plastic@NelsonCompany.com

www.NelsonCompany.com

www.NelsonTechCenter.com

NPP-4840-FP-E6OD-FDA

48x40 (Standard)
Plastic Industrial Pallet



Technical Drawings

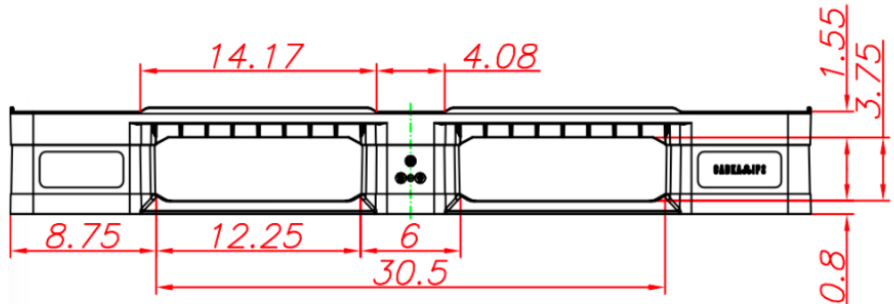
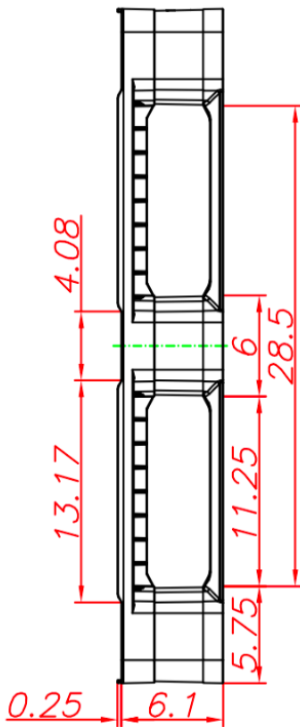
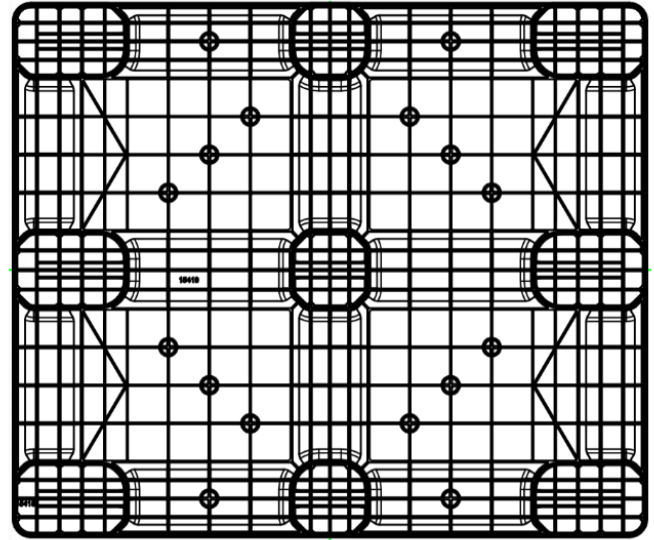
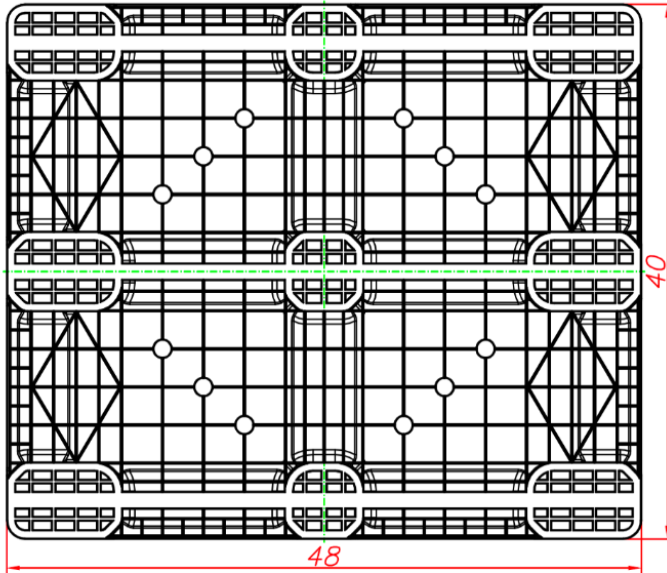

Nelson™

The Nelson Company
(443) 649-5294

plastic@NelsonCompany.com

www.NelsonCompany.com

www.NelsonTechCenter.com

Tech Sheet Generated On: 1/28/2023
Specifications subject to change without notice.
Contents of this document are presented for general informational purposes only. Technical data are guideline values based on experience and tests under defined conditions. The data may vary based on intended use, product features, raw materials used and environmental influences. Nothing in this document shall be construed as warranties or guarantees, express or implied, regarding the products or their use, application, performance or otherwise.